

**HOLLAND CHARTER TOWNSHIP / PARK TOWNSHIP
RETAIL SANITARY SEWER SYSTEM CONTRACT AMENDMENT**

This Amendment (“**Amendment**”) to the Holland Charter Township / Park Township Retail Sanitary Sewer System Contract (“**Contract**”) is made by Holland Charter Township (“**Holland**”) and Park Township (“**Park**”).

This Amendment is based upon the following facts and circumstances.

- A. Holland and Park have previously entered into the Contract.
- B. The Contract pertains to the Holland sanitary sewer system (“**Holland System**”) and the Park sanitary sewer system (“**Park System**”).
- C. The Contract governs the construction of sewer lines for the Park System and the maintenance and service of those Park System sewer lines. Nonetheless, with regard to the sewer line addressed by this Amendment, the maintenance and service shall be governed by this Amendment, not the Contract.

HOLLAND AND PARK AGREE AS FOLLOWS.

1. A sewer line shall be constructed in James Street, from Wild Stem Drive westerly to 160th Avenue, as shown on the attached **Exhibit A (“Sewer Line”)**. The Sewer Line shall be an 8 inch gravity-fed main of 900 linear feet. However, the parties acknowledge that the master sanitary sewer plan for the Consolidated Sewer System (as defined in the Contract) calls for the Sewer Line to be a 12 inch line rather than an 8 inch line.

2. Notwithstanding the Contract, if and when the Sewer Line must be increased to 12 inches for necessary capacity, as determined by the Consolidated Sewer System after consultation with its engineers and with the approval for the increased Sewer Line size by Park, the cost to expand the Sewer Line from 8 inches to 12 inches shall be paid exclusively by Park, and no part of that cost shall be paid by the Consolidated Sewer System. In no case shall the Sewer Line size be increased until written approval has been provided by Park, such approval not to be unreasonably denied or delayed. If Park denies approval of the increased Sewer Line size, and Holland is in disagreement with Park, then Holland shall have the option, on notice to Park, to have the issue of whether the increased Sewer Line size is necessary for the Park System determined by an independent board of engineers selected as provided in Section 5 of the Contract, The decision of the majority of the engineers shall be binding on all parties.

3. Other than this Amendment, the Contract shall remain in full force and effect. The Amendment shall remain in effect as long as the Contract is in effect.

(remainder of this page intentionally left blank)

The parties have executed and delivered this Agreement on the dates set forth below.

HOLLAND CHARTER TOWNSHIP

PARK TOWNSHIP

By: _____
Printed Name: _____
Its: _____

By: _____
Printed Name: _____
Its: _____

By: _____
Printed Name: _____
Its: _____

By: _____
Printed Name: _____
Its: _____

Dated: _____

Dated: _____

EXHIBIT A

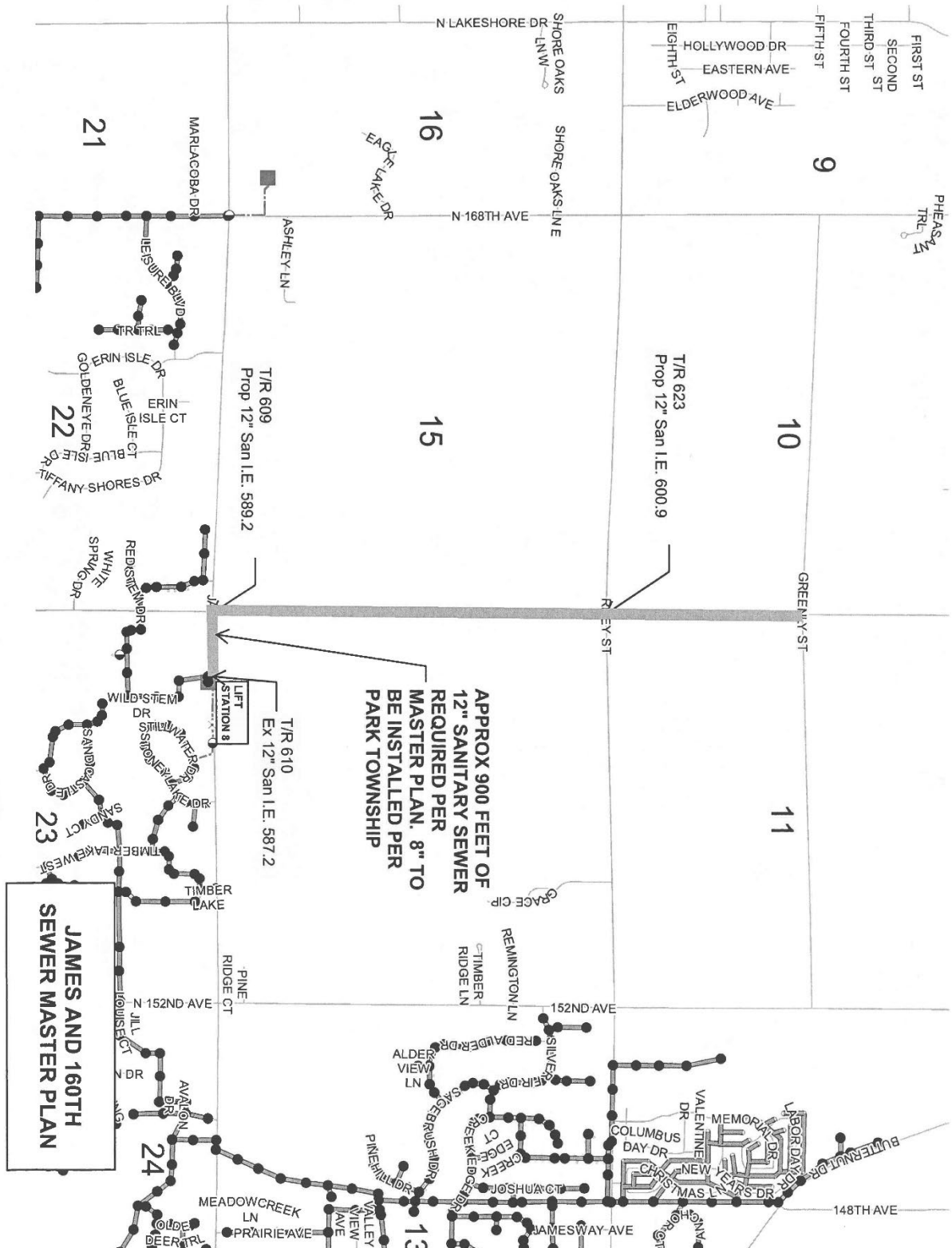

**JAMES AND 160TH
SEWER MASTER PLAN**